

RELIEF REGULATORS SB SERIES

FEATURES

- | | |
|--|----------|
| • Max. operating pressure: | 1.5 bar |
| • Max. operating temperature: | 65 °C |
| • Low loading pressure rise for full stroke; | |
| – 4 oz spring | 3.8 mbar |
| – 16 oz spring | 7.6 mbar |

APPLICATIONS

- Relief valve on positive displacement pumps.
- Vent regulators on atmosphere generators.
- High capacity safety vent regulators downstream of reducing regulator stations.
- By-pass valves.



DESCRIPTION

SB relief regulators hold pressure in pipes below the maximum value. The top diaphragm loading connection is directly connected from a remote signal source. The pressure inside the regulator will remain the same as spring setting. The valve opens as inlet pressure rises.

INSTALLATION

All relief regulators are tested, set and sealed when shipped. If adjustment or repair is necessary, the regulator should be returned to the factory.

Regulators must always be mounted in a stem-up position, in a horizontal line. Any other mounting position will cause a malfunction. The arrow cast on the side of the valve body indicates direction flow.

Regulators should not be installed in areas where operating temperatures will exceed 65° C.

CAPACITY TABLE

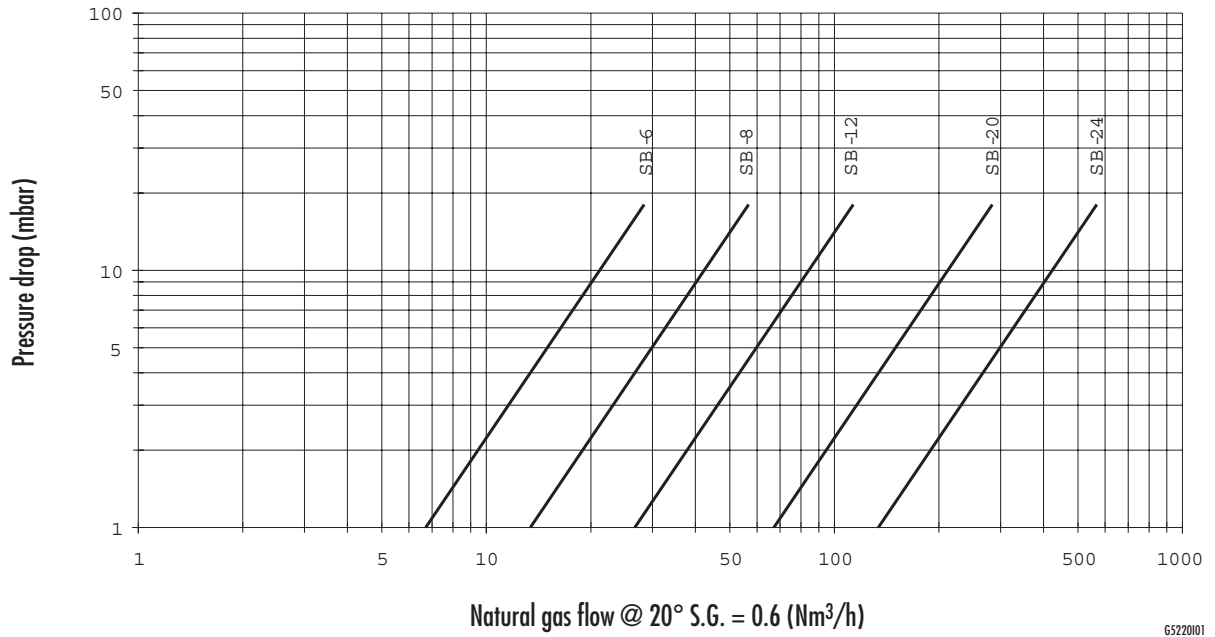

SPRING RANGES

Spring number	Spring colour	Spring adjustment range Start to stroke setting	
		Minimum (mbar)	Maximum (mbar)
0	plain	0	2.5
4 OZ	red	2.5	20.0
16 OZ	orange	18.0	75.0
48 OZ*	white	53.0	210.0

* Spring 48oz not available on SB20 and SB24.

TYPICAL RELIEF REGULATOR PERFORMANCE STROKE PRESSURE vs FLOW

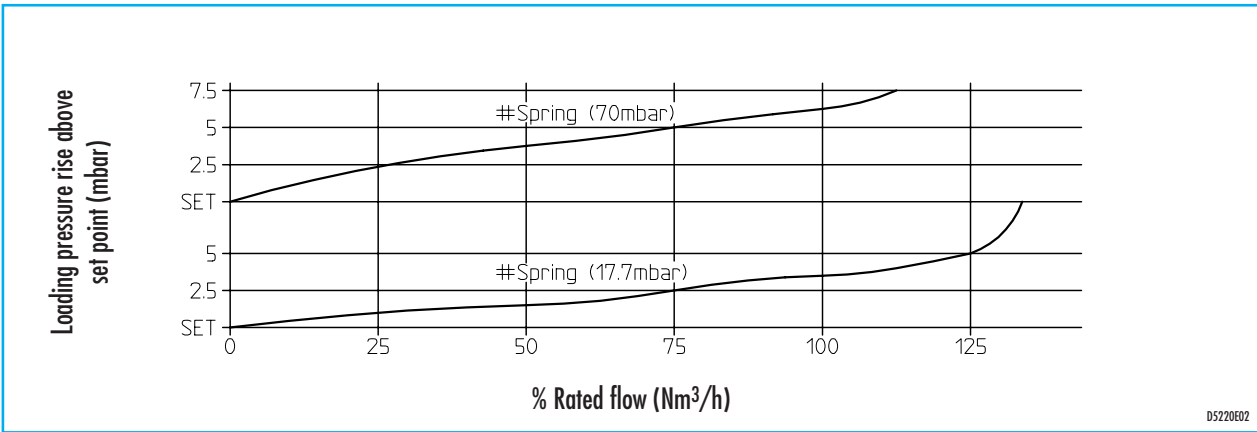

D5220E02

DIMENSIONS

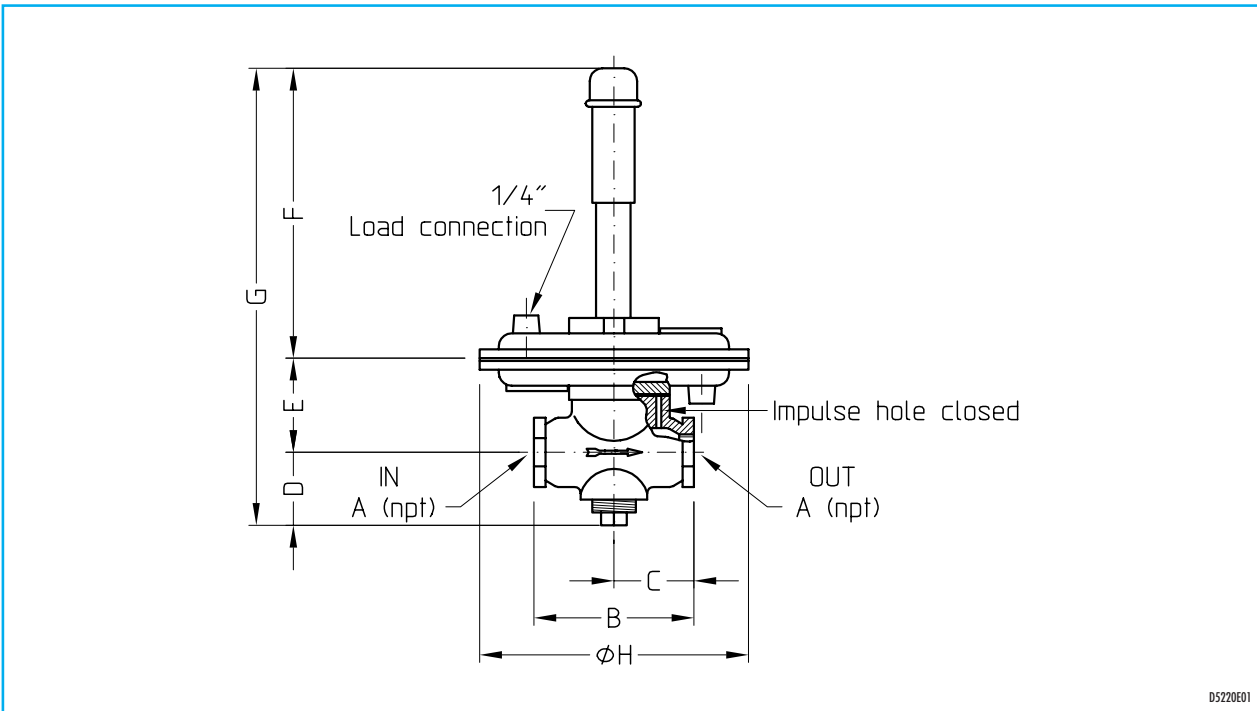

D5220E01

Catalog no.	ø In npt	ø Out npt	C mm	D mm	E mm	F mm	G mm	H mm	Weight kg
SB 6	3/4"	3/4"	127	64	75	398	527	210	6
SB 8	1"	1"	120	60	72	398	521	248	9
SB 12	1.1/2"	1.1/2"	165	89	98	400	583	298	12
SB 20	2"	2"	216	114	125	606	829	256	23
SB 24	3"	3"	292	146	151	524	784	256	33

NOTE: Based on the company's policy aimed at a continuous improvement on product quality, ESA-PYRONICS reserves the right to bring changes to the technical characteristics of this device without previous notice. Our catalog updated to the latest version is available on our web site www.esapyronics.com and it is possible to download modified documents

WARNING: When operating, this combustion system can be dangerous and cause harm to persons or damage to equipment. Every burner must be provided with a protection device that monitors the combustion. The installation, adjustment and maintenance operations should only be performed by trained and qualified personnel.

